

Keys

Our Keys are ergonomic, versatile and easy to use, providing you with the perfect detacher solution for any of our products.



Keys

Product Line



S3™ Handkeys

page 84



Multi-Detacher™

page 85



Hard Tag Detachers

page 86



Hyper S3 Key

page 87



Super S3 Key

page 88



S3x Keys

page 89

Keys

S3™ Handkeys

S3 HandKeys offer superior aesthetics, ergonomic improvements and ease of use, with the trusted level of security you have come to expect. Serial numbers provide added security. The S3 HandKeys will open the entire line of S3 products.

KEY FEATURES:

The patented S3 HandKey is available in four configurations:

- **Standard S3 HandKey** is equipped with a 60" coiled lanyard that bolts directly into the POS and provide easy access and manageability
- **S3 HandKey and Dock** comes with a convenient dock that is attached at the POS for storage when not in use
- **S3 Locking Counter Key** has the same specialized magnet array with in an ergonomic handset that fits into a locking cradle for added security
- The **S3 Locking Alarming Counter Key** has a 95 dBA alarm that will signal when the lanyard has been compromised



S3 HandKey and Lanyard (S3HKCL)



S3 HandKey and Dock (S3HKSLKD)



S3 Locking Counter Key (S3KEY)



S3 Locking Alarming Counter Key (S3AKEY)

ORDER CODE	SAP CODE	DESCRIPTION	EXTERNAL DIM. (L x W x D)	CARTON QTY.
S3HKSLKDND	10006401	S3 HandKey and Key Dock, AM	4.65"L x 0.85"W x 0.50"H	1
S3HKSLKDRF	10006402	S3 HandKey and Key Dock, RF	(11.81cmL x 2.16cmW x 1.27cmH)	1
S3HKCLND	10006398	S3 HandKey and 60" Lanyard, AM	4.50"L x 1.00"W x 0.75"H	1
S3HKCLRF	10006399	S3 HandKey and 60" Lanyard, RF	(11.43cmL x 2.15cmW x 1.91cmH)	1
S3KEY	10006347	S3 Locking Counter Key	5.75"L x 1.75"W x 1.75"H	1
S3AKEY	9286317	S3 Locking Alarming Counter Key	(14.61cmL x 4.45cmW x 4.45cmH)	1
S3HKRND	10006400	S3 HandKey w/Belt Retractor, AM	4.50"L x 1.00"W x 0.75"H	1
S3HKRFLRL	9409394	S3 HandKey w/Belt Retractor, RF	(11.43cmL x 2.15cmW x 1.91cmH)	1
AF3303	9283051	Barrel Keys, 2 Pack		2
KIT-BATTERY-SCREWDRIVER	10111909	Battery Replacement Kit: T6 Torx Screwdriver and CR2450 Replacement Battery		1

Keys

Multi-Detacher™



Instruction video

In addition to the ergonomics and the S3 magnet set of the S3™ HandKey, the Multi-Detacher Counter Key also boasts a Standard Lock magnet to widen its versatility. This secure, one-key solution will unlock the entire line of Checkpoint S3 solutions as well as select Standard Lock solutions.

KEY FEATURES:

- Serial number provides added security
- 60" lanyard
- HandKey offers flexibility for personnel on the floor
- S3 magnet
- Standard Lock magnet



Open position



Handkey



Can be locked when not in use

Barrel Keys for Locking (AF3303)



Closed position

ORDER CODE	SAP CODE	DESCRIPTION	EXTERNAL DIM. (L x W x D)	CARTON QTY.
S3MDKEYST	9414839	Multi-Detacher Counter Key Non Alarming	5.75"L x 1.75"W x 1.75"H (14.61 cmL x 4.45 cmW x 4.45 cmH)	1
KY1423*	10111227	Multi-Detacher HandKey w/Belt Retractor	4.47"L x 0.97"W x 0.89"H (12.62 cmL x 2.46 cmW x 2.26 cmH)	1
AF3303	9283051	Barrel Keys, 2 Pack		2

* This product is available only as MTO (make to order).

Keys

Hard Tag Detachers

Checkpoint hard tag detachers offer superior aesthetics, ergonomic improvements and ease of use, with the trusted level of security you have come to expect. The compact design of these detachers maintain a high level of security.

PIN FEATURES:

- Fast one-handing checkout
- Easy to use
- Standard or Super Lock magnet
- Smart design maximising hard tag removal at POS



ORDER CODE	DESCRIPTION	EXTERNAL DIM. (DIAMETER)	CARTON QTY.
10104110	DETACHER SUPERLOCK RND - NICKEL CKP	55mm	1
10114333	ACC. FOR SUPER DETACHER - PLASTIC HOUSIN	75mm	1
9162263	ACC. SUPER DETACHER - PLASTIC COVER 57MM	57mm	1
9162218	ACC. SUPER DETACHER - TUBULAR HAND GRIP	-	1
9162219	ACC. SUPER DETACHER - TUBULAR KEY RING	-	1
10106181	DETACHER-SPRLK-D400	69mmL x 28mmW	1
9509475	Spare Cover Kit for D400 Detacher	-	1
9238056	DETACHER GOLF TAG	-	1
9238054	DETACHER DOUBLE FORCE STANDARD	52mmL x 38mmW	1

Keys

Hyper S3™ Key

The Hyper S3 key unlocks the strongest clutch strength products in the Checkpoint portfolio. It is backwards compatible, able to unlock the entire line of S3, Standard Lock, Super Lock, and Hyper Lock products. The deployable handheld portion is attached to the mounted base with a robust 60" cable to keep the key secure while maintaining its flexibility.

KEY FEATURES:

- Serial number provides added security
- 60" cable lanyard
- Unlocks the entire line of S3, Standard Lock, Super Lock, and Hyper Lock products



Hyper S3 Portable Key (Open)

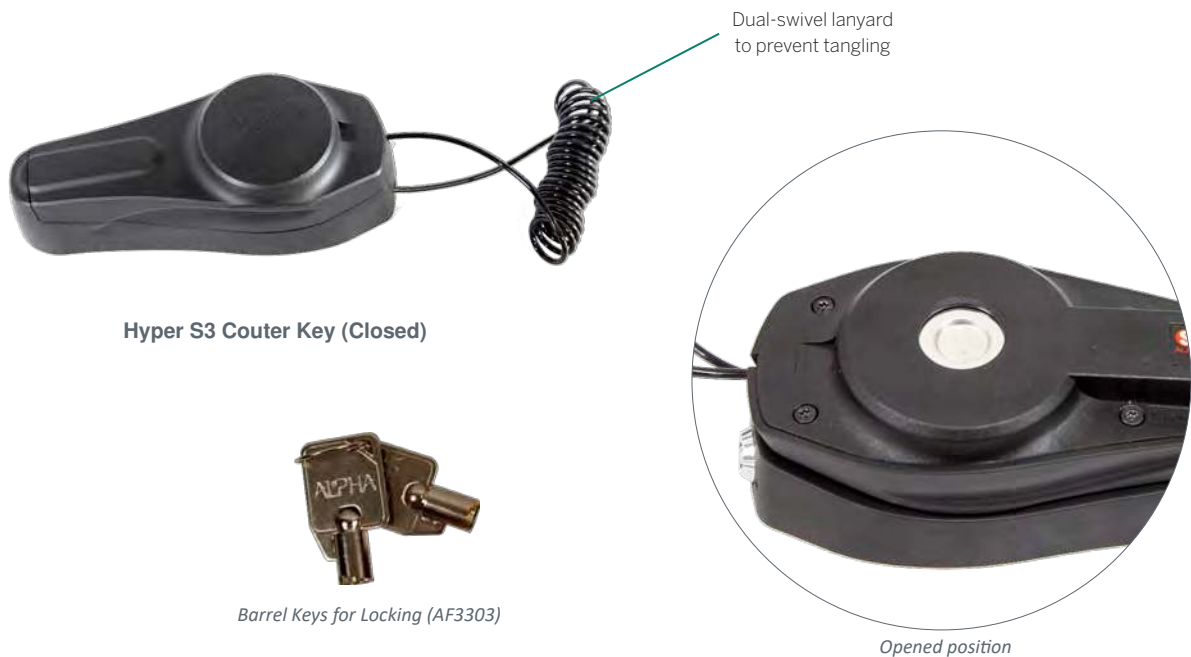

Hyper S3 Couter Key (Closed)

Barrel Keys for Locking (AF3303)

Opened position

ORDER CODE	SAP CODE	DESCRIPTION	EXTERNAL DIM. (L x W x D)	CARTON QTY.
HYPERS3KEY-BLK-60IN	10148266	Hyper S3 Key, Black, 60 Inch Lanyard	6.9"L x 2.9"W x 2.1"D (15.24cmL x 5.08cmW x 5.08cmH)	10
AF3303	9283051	Barrel Keys, 2 Pack		1

Keys

Super S3™ Key



Instruction video

This next generation of super detacher, based on our Multi-Detacher ergonomic aesthetic, has been designed for ease of use, providing the perfect detacher solution for any of our products. The Super S3 Key provides both form and function and is the strongest detacher in our portfolio.

KEY FEATURES:

- Ergonomically enhanced for easier handling
- Sturdier design able to better withstand rough retail environment
- Lighter than previous Super XT version due to separate magnet sets being used
- Dual-swivel lanyard to prevent tangling
- 36" or 60" coiled lanyard
- S3, Standard Lock and Super Lock detaching
- Can be locked in either open, when being used, or closed position to prevent un-authorized item removal
- Serial number provides added



Super S3 Portable Key (Open)



Super S3 Couter Key (Closed)



Barrel Keys for Locking (AF3303)



Opened position

ORDER CODE	SAP CODE	DESCRIPTION	EXTERNAL DIM. (L x W x D)	CARTON QTY.
KY1554-SS3KEY-B-60IN	10144026	Super S3 Key, Black, 60" Lanyard	5.75"L x 2.3"W x 1.65"H (14.6cmL x 6.0cmW x 4.2cmH)	1
KY1554-SS3KEY-B-BELT	10144027	Super S3 Key with Belt Retractor, 36" Lanyard	5.75"L x 2.3"W x 1.65"H (14.6cmL x 6.0cmW x 4.2cmH)	1
AF3303	9283051	Barrel Keys		2

Keys

S3x Keys

S3x Keys provide enhanced locking security when used with S3vx devices. S3x Keys open the following devices:

- S3vx AVM606 Keeper
- S3vx AVM806 Keeper
- S3vx AVM966 Keeper
- S3vx 2 Alarm Attack Spider Wrap®
- S3vx 2 Alarm Mini Spider Wrap®
- S3vx 2 Alarm Mini CableLok®

KEY FEATURES:

- Key is backwards compatible and will open existing S3 devices
- Standard Lock magnet on S3x Multi-Key widens versatility
- Can be locked when not in use
- Serial number provides added security

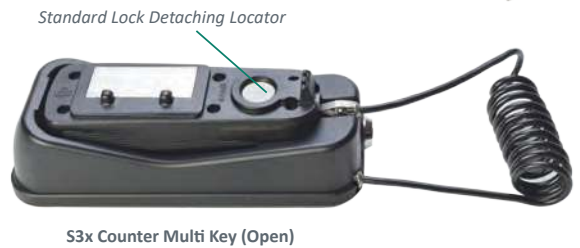

Barrel Keys for Locking (AF3303)

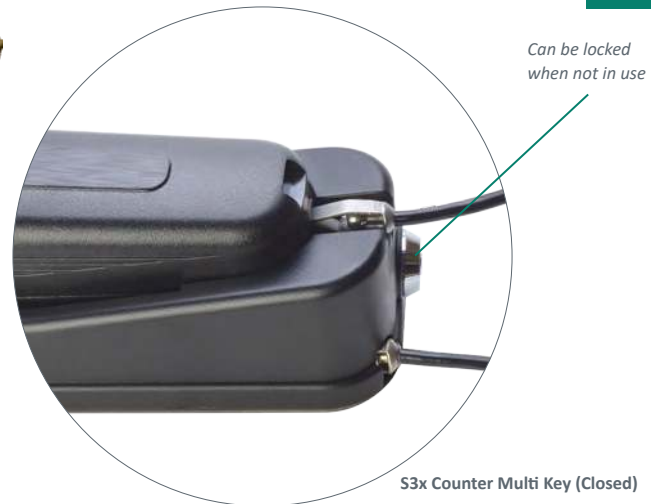

ORDER CODE	SAP CODE	DESCRIPTION	EXTERNAL DIM. (L x W x D)	CARTON QTY.
KY1481S3XCNTR	10117387	S3x Counter Key	6.25"L x 2.43"W x 1.65"H (16.0cmL x 6.2cmW x 4.2cmH)	1
KY1481S3XPORT	10117388	S3x Portable Key w/Recoiler	4.70"L x 1.57"W x 1.07"H (12.0cmL x 4.0cmW x 2.7cmH)	1
KY1481S3XMULTI	10117389	S3x Counter Multi-Key	6.25"L x 2.43"W x 1.65"H (16.0cmL x 6.2cmW x 4.2cmH)	1
KY1481S3XPORTMULTI	10117983	S3x Portable Multi-Key w/Recoiler	4.70"L x 1.57"W x 1.07"H (12.0cmL x 4.0cmW x 2.7cmH)	1
AF3303	9283051	Barrel Keys, 2 Pack		2

NOTE: All these products are available only as MTO (make to order)